

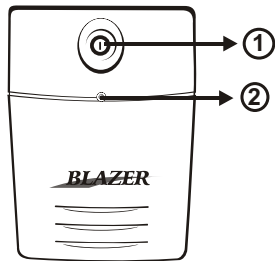

## System Description

### Front Panel--

1. Power Switch
2. LED Indicators --  
AC Mode: Green Lighting  
Battery Mode: Green Flashing



### Back Panel--

1. Output receptacles
2. AC Input with AC fuse
3. Modem/Phoneline Surge Protection
4. Communication Port

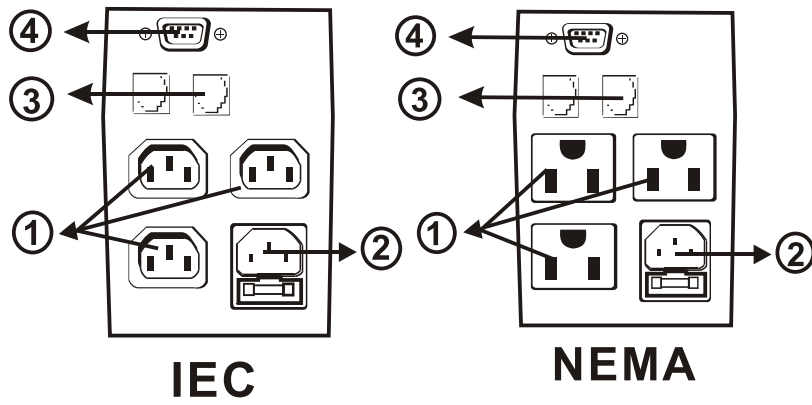

## Specification

MODEL		Blazer 400	Blazer 600	Blazer 800
CAPACITY	VA/W	400VA/240W	600VA/360W	800VA/480W
INPUT	VOLTAGE	115VAC or 220/230/240VAC		
	VOLTAGE RANGE	90-140VAC or 165-280VAC		
	FREQUENCY	47-63 Hz (Auto Sensing)		
OUTPUT	VOLTAGE	115/220/230/240VAC		
	VOLTAGE REGULATION (Batt. Mode)	+/-10%		
	FREQUENCY	50Hz or 60Hz		
	FREQUENCY REGULATION (Batt. Mode)	+/-1 Hz		
	OUTPUT WAVEFORM	MODIFIED WAVEFORM		
	BATTERY	BATTERY TYPE & NUMBER	6V/4AH x 2pcs	12V/7AH x 1pc
BACK UP TIME AT HALF LOAD		10 MINUTES	8 MINUTES AT HALF LOAD	
RECHARGE TIME		8 HOURS TO 90% AFTER COMPLETE DISCHARGE		
TRANSFER TIME	TYPICAL	LESS THAN 3MS		
INDICATOR	AC MODE	GREEN LIGHTING		
	BACKUP MODE	GREEN FLASHING		
AUDIBLE ALARM	BACKUP MODE	SOUNDING EVERY 10 SECONDS		
	BATTERY LOW	SOUNDING EVERY 1 SECOND		
	OVERLOAD	SOUNDING EVERY 0.5 SECONDS		
	FAULT	CONTINUOUS SOUNDING		
PROTECTION	FULL PROTECTION	DISCHARGE, OVERCHARGE, AND OVERLOAD PROTECTION		
PHYSICAL	DIMENSION (MM), DXWXH	330X100X140		
WEIGHT	NET WEIGHT	5KGS	6KGS	6.5KGS
	OPERATING ENVIRONMENT	0- 40° C, 0-90 % RELATIVE HUMIDITY (NON-CONDENSING)		
ENVIRONMENT	NOISE LEVEL	LESS THAN 40dB		
	INTERFACE	SMART RS-232	SUPPORT WINDOWS 95/98/NT/2000, NOVELL AND LINUX	



## Trouble Shooting

Symptom	Possible Cause	Remedy
No LED display on the front panel.	1. Missing battery.	1. Charge battery up to 8 hours.
	2. Battery defect.	2. Replace with the same type of battery.
	3. Power switch is not pressed at least 5 seconds.	3. Press and Hold power switch for at least 5 seconds.
Alarm buzzer beeps continuously when AC supply is normal.	Overload of the UPS.	Verify that the load matches the UPS capability specified in the specs.
When power failure, back-up time is shorten.	1. Overload of the UPS.	1. Remove some noncritical load.
	2. Battery voltage is too low.	2. Charge battery 8 hours or more.
	3. Battery defect due to high temperature operation environment, or improper operation to battery.	3. Replace with the same type of battery.
Mains normal but LED is flashing.	1. Fuse is blown.	1. Replace the same type of fuse.
	2. Power cord is loose.	2. Reconnect the power cord properly.

If any abnormal situations occur that are not listed above, please call service people immediately.

28-2BLA000011

## Uninterruptible Power Supply

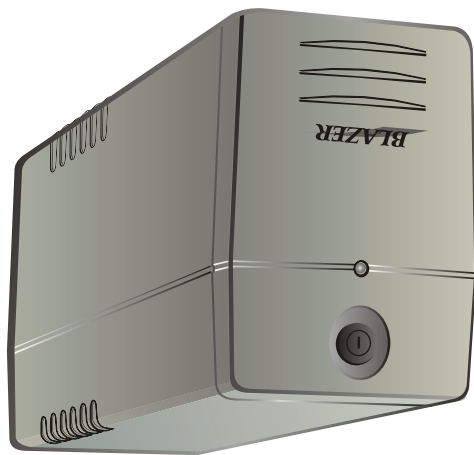

4th Edition, 2002

# Blazer UPS

# USER MANUAL

- ### Wichtige Sicherheitshinweise
- Bitte lesen Sie diese Hinweis sorgfältig durch.
  - Vor jedem reinigen ist das Gerät vom Stromnetz zu trennen. Verwenden Sie keine Flüssig- oder Aerosolreiniger. Am besten eignet sich ein angefeuchtetes Tuch zur Reinigung.
  - Das Gerät ist vor Feuchtigkeit zu schützen.
  - Öffnen Sie niemals das Gerät. Das Gerät darf aus Gründen der elektrischen Sicherheit nur von autorisiertem Servicepersonal geöffnet werden.
  - Bei der Installation ist darauf zu achten, dass der Gesamtbleistrom der USV und der and der USV angeschlossenen Verbraucher den. Maximalwert von 3.5mA nicht überschreiten.
  - VORSICHT: Explosionsgefahr bei unsachgemäßem Austausch der Batterie. Ersatz nur durch denselben oder einem vom Hersteller empfohlenem ähnlichen Typ. Entsorgung gebrauchter Batterien nach Angaben des Herstellers.
- ### Safety -- Caution!!
- Do not dispose of batteries in a fire as they may explode.
  - Do not open or mutilate the battery or batteries. Release electrolyte is harmful to the skin and eyes. It may be toxic.
  - A battery can present a risk of electrical shock and high short circuit current. The following precautions should be observed when working on batteries:
    - 1) Remove watches, rings, or other metal objects from the hands.
    - 2) Use tools with insulated handles.
    - 3) Wear rubber gloves and boots.
    - 4) Do not lay tools or metal parts on top of batteries.
    - 5) Disconnect charging source prior to connecting or disconnecting batteries terminal.
  - Service of batteries should be performed or supervised by personnel knowledgeable of batteries and the required precautions. Keep unauthorized personnel away from batteries.
  - When replacing batteries, replace with the same number and type of sealed lead-acid battery.

- ### IMPORTANT SAFETY INSTRUCTION
- Important instructions for models Blazer 400, Blazer 600, Blazer 800 that should be followed during installation and maintenance of the UPS and batteries.
- ### Safety -- Caution!!
- This UPS utilizes voltage that may be hazardous. Do not attempt to disassemble the unit. The unit contains no user replaceable parts. Only factory service personnel may perform repairs.
  - Internal battery voltage is 12Vdc.
  - Connection to any other type of receptacle other than a two-pole, three-wire grounded receptacle may result in shock hazard as well as violate local electrical codes.
  - In the event of an emergency, press the "OFF" button and disconnect the power cord from the AC power supply to properly disable the UPS.
  - Do not allow any liquids or any foreign object to enter the UPS. Do not place beverages or any other liquid-containing vessels on or near the unit.
  - This unit intended for installation in a controlled environment (temperature controlled, indoor area free of conductive contaminants). Avoid installing the UPS in locations where there is standing or running water, or excessive humidity.
  - Do not plug the UPS input into its own output.
  - Do not attach a power strip or surge suppressor to the UPS.
  - Do not attach non-computer-related items, such as medical equipment, life-support equipment, microwave ovens, or vacuum cleaners to UPS.
  - To reduce the risk of overheating the UPS, do not cover the UPS cooling vents and avoid exposing the unit to direct sunlight or installing the unit near heat emitting appliances such as space heater or furnaces.
  - Unplug the UPS prior to cleaning and do not use liquid or spray detergent.



## Introduction

This UPS is specially designed for Personal Computer with multi-functions. Its light weight, compact design perfect fits to the limited working environment. The line of UPS is equipped with boost and buck AVR to stabilize input voltage range. It is also built-in with DC start function. This function enables the UPS to be started up without AC power supplied. Although it's a small UPS, it's equipped with Smart RS-232 Communication Port to offer users more benefits. The download software helps users monitor UPS inside status. The main features of Blazer UPS are listed below:

- Microprocessor control guarantees high reliability.
- Equipped with Boost and Buck AVR to stabilize the input voltage.
- DC Start Function.
- Built-in RS-232 Communication Port.
- Free Software Download from the Internet. (Please check Free Software Download for detail information.)
- Green Power Function for energy saving.
- Auto restart while AC recovery.
- Compact size, Light weight.
- Provides Modem and Phonenumber Surge Protection
- Provide AC Overload Protection.



## Installation and Operation

Installing the Blazer is as easy as following the steps shown. Be aware of the Power Switch must be kept in the "ON" position, otherwise, the UPS will be disabled and your equipment will not be protected during a power failure.

### 1

#### Inspection

Remove the UPS from its package and inspect it for damage that may have occurred during shipping. If any damage is discovered, re-pack the unit and return it to the place of purchase.

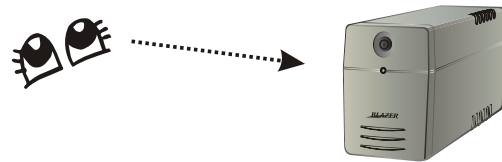

### 2

#### Placement

Install the UPS unit in any protected environment that provides adequate airflow around the unit, and is free from excessive dust, corrosive fumes and conductive contaminants. Do not operate your UPS in an environment where the ambient temperature or humidity is high.



On the other hand, place the UPS unit away from the monitor at least 20cm to avoid interference.

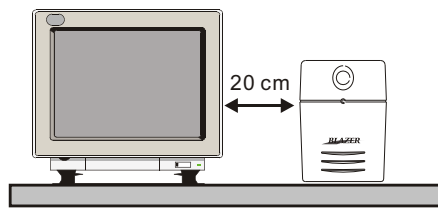

### 3

#### Charging

This unit is shipped from the factory with its internal battery fully charged, however, some charge may be lost during shipping and the battery should be recharged prior to use. Plug the unit into an appropriate power supply and allow the UPS to charge fully by leaving it plugged in for at least 8 hours.

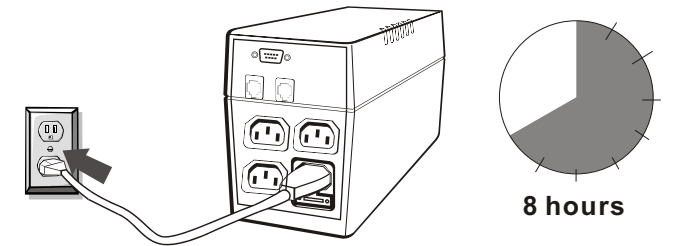

### 4

#### Computer Connection

Connect one computer-related device into each of the power receptacles supplied on the back of the UPS.

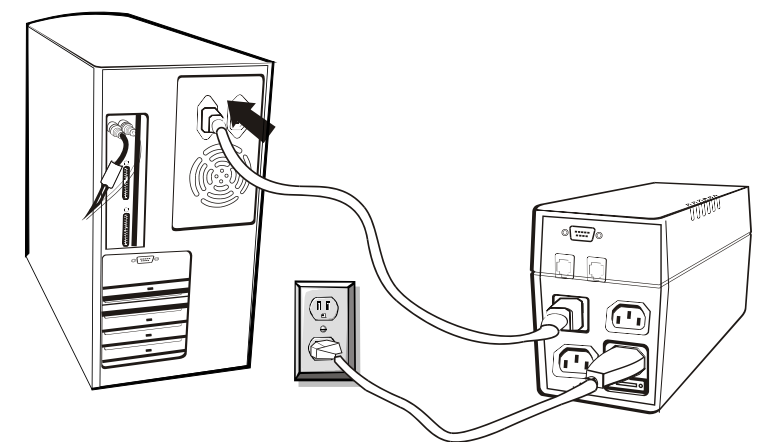

### 5

#### Modem/Phonenumber Connection

Plug incoming internet line into the "In" socket at the back of the Blazer UPS. Use on more Internet line cable and plug one end of the Internet line cable to the "Out" socket at the back of Blazer UPS. Plug the other end of the modem input socket as shown below.

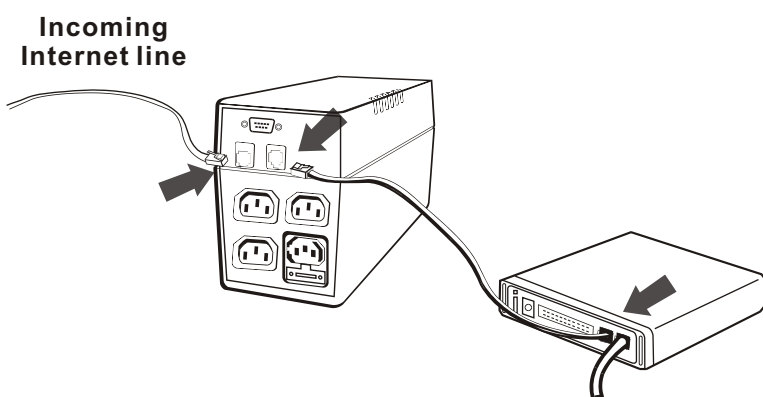

### 6

#### Serial cable Connection

To allow for unattended system shutdown for your operating system, connect the serial cable as per diagram below.

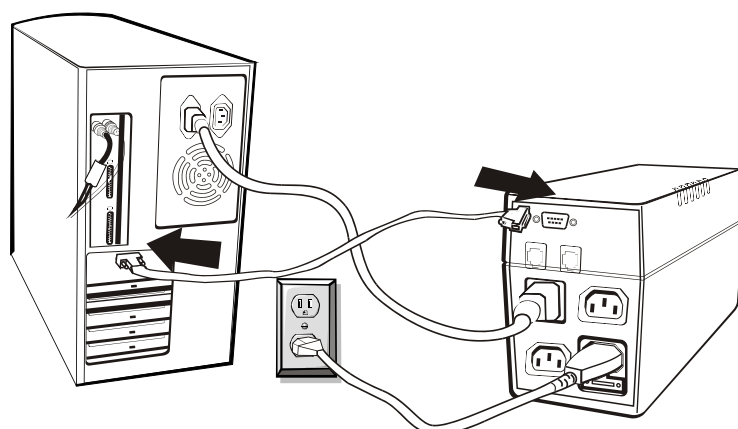

### 7

#### Turn On/Off

Blazer Series will be turned on automatically at first plug-in. At this moment, press power switch lightly to turn off the UPS. To turn on the UPS again, just simply press power switch again. Please DO NOT punch it for extended life of the power switch.

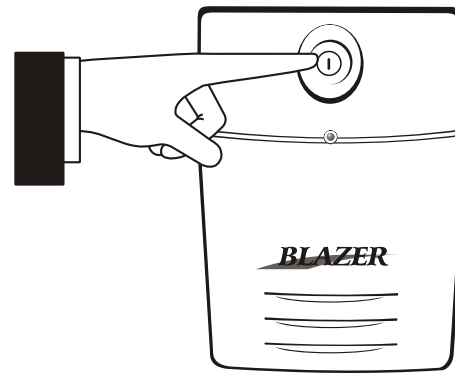

### 8

#### DC Start Function

DC Start Function enables UPS to be started up when AC utility power is not available and battery is fully charged. Just simply press the power switch to turn on the UPS.

### 9

#### Green Power Function

All Blazer Series are equipped with Green Power Function. If no load connects to the UPS, it will automatically shut down in 5 minutes for energy saving while power failure. The UPS will restart while AC recovery.



## Free Software Download -- Commander Pro --

Commander Pro is a unique uninterruptible power supply (UPS) control software that offers you unprecedented convenience for the control of any UPS.

#### Features:

- Saves files before shutdown occurs
- Scheduled system shutdown
- Graphic display of UPS status
- Warning notification via E-mail
- User-friendly interface
- Multi-language versions

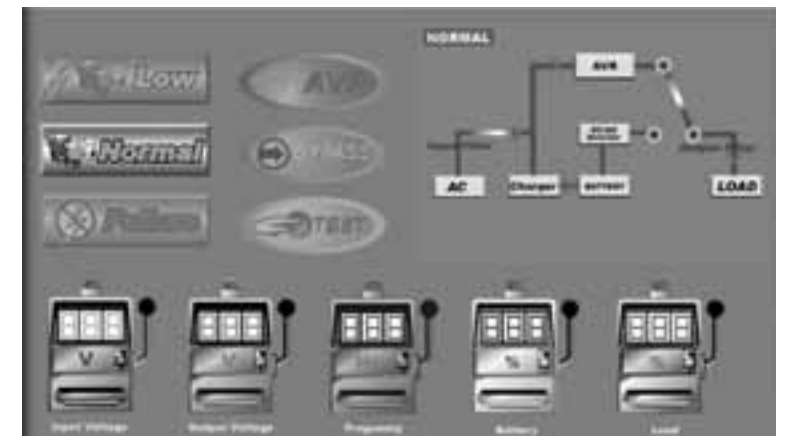

Download Commander Pro from the internet is a simple process:

1. Go to Website <http://www.ups-software-download.com>
2. Click Commander Pro Icon to enter software download area.
3. Choose operating system you need for your PC and double click to download software automatically.
4. Type in Serial No: 511C1-01220-0100-478DF2A to install the software.